

COTTONWOOD COUNTY MINNESOTA

5 YEAR PLAN FOR HIGHWAY CONSTRUCTION PROJECTS

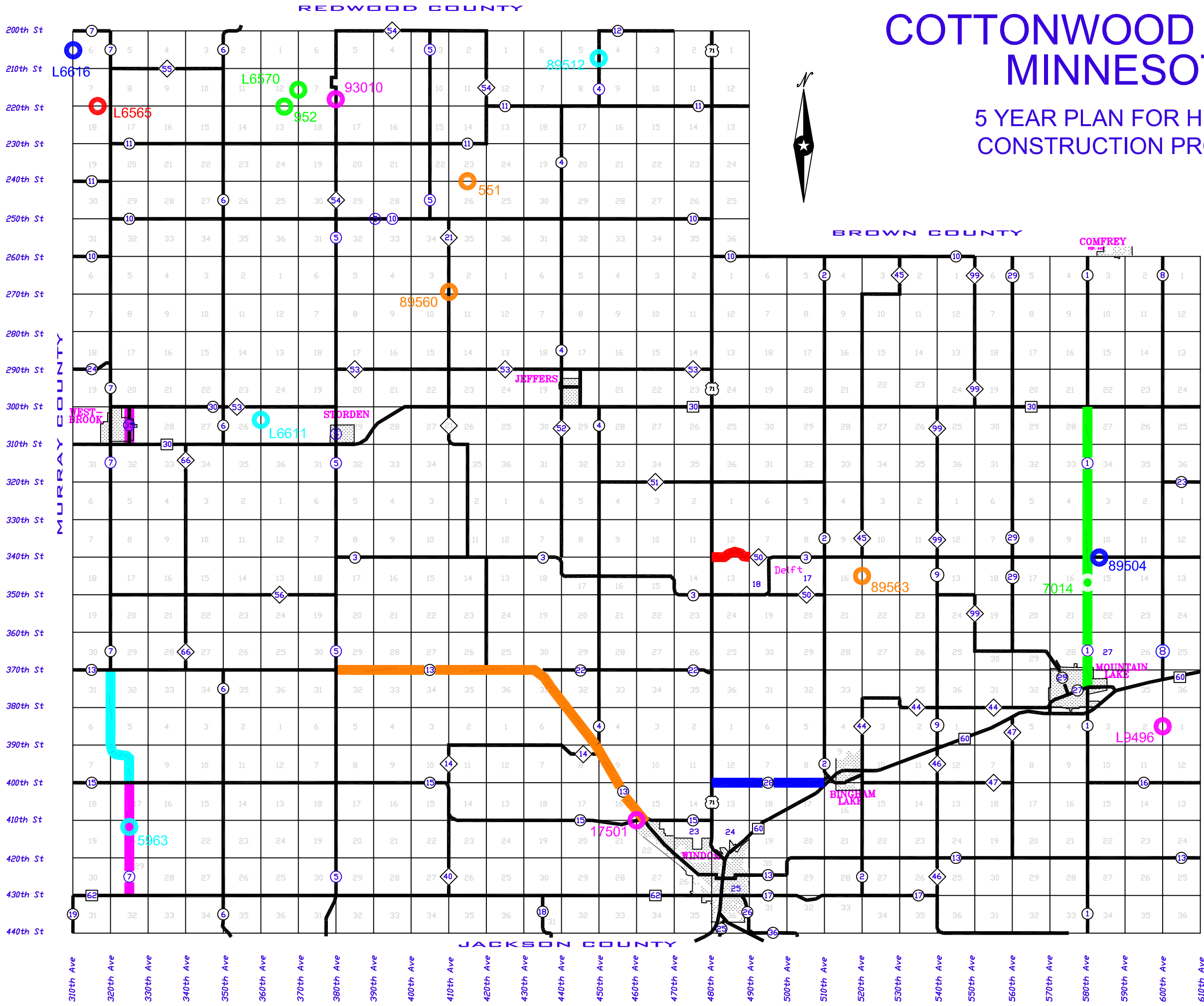

2017

- * CSAH 1 - PCC OVERLAY
- * 952 - ANN TOWNSHIP (BOX CULVERT)
- * 7014 - CSAH 1 (BRIDGE)
- * L6570 - ANN TOWNSHIP (BRIDGE)

2018

- * 89512 - CSAH 4 (BRIDGE)
- * L6611 - WESTBROOK (BOX CULVERT)
- * 5963 - CSAH 7 (BRIDGE)
- * CSAH 7 - 3.5 MI. N. SHLDR WIDEN/BIT SURF

2019

- * CSAH 7 - 3 mi. S. SHLDR WIDEN. BIT SURF
- * CSAH 33 - GRADE/PAVE
- * 93010 - CR 54 (BRIDGE)
- * L9496 - MT LAKE (BRIDGE/BX CULVERT)
- * 17501 - CSAH 15 (BRIDGE REHAB)

2020

- * CSAH 28 - SHLDR / MILL / PAVE
- * 89504 - CSAH 3 (BRIDGE)
- * L6616 - ANN (BOX CULVERT)

2021

- * CSAH 13 - Mill/Pave
- * 89563 - CARSON (BRIDGE)
- * 551 - Highwater (BRIDGE)
- * 89560 - CR 21 (BRIDGE)

2022

- * CSAH 50 - Shld. Widen/Bit Surface
- * L6565 - Ann (BOX CULVERT)

WATONWAN COUNTY

MURRAY COUNTY

REDWOOD COUNTY

BROWN COUNTY

JACKSON COUNTY

200th St
210th St
220th St
230th St
240th St
250th St
260th St
270th St
280th St
290th St
300th St
310th St
320th St
330th St
340th St
350th St
360th St
370th St
380th St
390th St
400th St
410th St
420th St
430th St
440th St

310th Ave
320th Ave
330th Ave
340th Ave
350th Ave
360th Ave
370th Ave
380th Ave
390th Ave
400th Ave
410th Ave
420th Ave
430th Ave
440th Ave
450th Ave
460th Ave
470th Ave
480th Ave
490th Ave
500th Ave
510th Ave
520th Ave
530th Ave
540th Ave
550th Ave
560th Ave
570th Ave
580th Ave
590th Ave
600th Ave
610th Ave